

Moorings 534PC

PRELIMINARY

Specifications and Equipment List - Moorings Upgrades In Bold

SALOON/INTERIOR

- **Faux Leather "Artesian" upholstery**
- Laminate finishes with solid wood trims
- Folding saloon table with two fixed legs
- Settee - L-shape
- Settee - two seater
- Wear resistant laminate flooring
- LED overhead lighting
- Stowage space under stbd settee cushions
- Front doorway access to foredeck

GALLEY

- Staron galley worktop surfaces
- Single lever mixer faucet with pull out sprayer
- Single stainless steel sink
- Dish and cutlery drying recess with drainage
- Double door domestic fridge
- 4-burner hob
- Convection microwave oven
- Gas solenoid shut-off valve with control at switch panel & warning light at cooker
- Gas detectors in each hull connected to alarm in saloon
- Gas cylinder regulator in dedicated LPG locker
- Separate garbage bin locker
- Stowage space in shelf lockers
- Spice rack
- 4 x Galley drawers
- 2 x Pot storage drawer below oven
- 1 x Large overhead storage locker
- Smoke detector / alarm

NAVIGATION CONSOLE

- Chart table with storage locker under hinged lid
- LED overhead lighting
- Backrest stainless steel railing
- Storage locker under chart table

CABINS x 4

- Laminate finishes
- Queen size berth (2025mm x 1720mm or 80" x 68")
- Bedside tables
- Headboard
- Hanging locker with lower shelf
- LED overhead lighting
- LED reading lamps
- Overhead roller blinds for privacy
- Large open shelves
- Stowage drawers under bunk
- Large hull window incorporating portlight and pleated blind
- Transom windows with pleated blind (aft cabins only)
- Carbon monoxide detector / alarm

FOREPEAKS

- Access from deck hatches only
- **Port forepeak includes:**
 - Mattress**
 - Air conditioning**
 - A/C electric outlet**
 - USB ports**
 - Fire Extinguisher**
- **Starboard forepeak includes:**
 - Basin with faucet & mirror**
 - Electric heads with dedicated holding tank**
 - Shower with shower curtain and automatic sump drain.**

HEAD COMPARTMENTS x 4

- Washbasin with basin mixer and Staron top
- Vanity locker with mirror
- Towel hook and rail
- Shower area with lever mixer and adjustable shower rose
- Shower sump with automatic drainage
- LED Overhead lighting
- Overhead roller blinds for privacy
- **Electric freshwater flushing toilets**

PLUMBING INSTALLATION

- Hot and cold pressurized fresh water system consisting of:
 - 2 x Water tanks, 185USgal / 700ltr total capacity with level reading and gauges
 - 2 x Fresh water pressure pump with accumulator tank
 - 2 x Hot water cylinders 12USgal / 46ltr total capacity
- **Hot & Cold Transom shower**
- 4 x Automatic shower drain pumps
- Holding tanks, 45USgal / 170ltr total capacity
- 2 x Electric bilge pumps (keel sump) with float switches and alarm at switch panel
- 2 x Manual bilge pumps
- 2 x High water bilge float switches with alarm at switch panel
- 2 x Electric bilge pumps (engine room) with flat switch and warning light at switch panel
- Freshwater connection
- **Watermaker**

DECK & HULL

- Stainless steel guard railing
- 2 x Stainless steel pushpits
- 2 x Pulpit seats (port & stbd)
- 1600w vertical windlass 10mm gypsy with hand held remote
- Anchor bow roller fitting for primary anchor
- Anchor bow roller fitting for secondary anchor
- Anchor chain stopper
- 1 x Chain locker
- 1 x Anchor/windlass locker
- 2 x Foredeck lockers
- Gas cylinder locker
- Sliding companionway door
- Hardtop over aft cockpit
- **Aft cockpit back shade curtains**
- L-shaped settee in aft cockpit with cushions and bolster
- Sunbed in aft cockpit with cushions and bolster
- Table in aft cockpit
- Swimming ladder
- Acrylic smoke grey tinted windows

DECK & HULL Cont.

- Hatches:
 - 2 x Size 44 Flush Hatch over cabins
 - 2 x Size 60 Flush Hatch on foredeck (vented)
- Portlights:
 - 10 x Size 1 in hull side and transom
- Foredeck lounging area with watertight saloon access door
- 2 x Forward facing sun loungers
- 4 x Drinks holders in forward cockpit
- 2 x Drinks holders in aft cockpit
- 2 x Stainless steel coachroof handrails
- 2 x Stainless steel aft hardtop grab handles
- 1 x 330mm mooring cleat in anchor locker
- 10 x 300mm s/s mooring cleats
- **Moorings exterior pack (logos, striping)**
- **Winch type lifting platform with fixed chocks**
- **Fitted cushions in aft cockpit and foredeck loungers**
- **2 x Bean bag chairs**

FLYBRIDGE

- Helm station console
- Staircase from aft cockpit to flybridge with LED courtesy lighting
- U-shaped upholstered settee
- Sunbed with mattress facing aft
- Wetbar unit with sink and faucet and GRP worktop
- **12V Refrigerator in flybridge wetbar**
- **Electric grill on flybridge wetbar**
- Life raft locker
- Stowage locker in wetbar
- Central fixed cocktail table with drink holder recess
- Guard railing around aft section of flybridge (s/s)
- Acrylic windscreen around fwd section of flybridge
- Hardtop over flybridge
- Hardtop supports
- **Flybridge enclosure front and sides only with aft sunshade curtain**
- Overhead lighting
- 2 x Pop-up lights
- 3 x Drinks holders

ENGINE & CONTROLS

- Double lever throttle / gearshift control
- Sound deadening panels in engine room
- 2 x Engine room ventilation fans and ducting
- 2 x Yanmar 350hp engines
- 2 x Propellers - 4-blade fixed
- 2 x Fuel deck fillers
- 2 x Fuel filter / water separators
- 2 x Composite fuel tanks 562USgal / 2130Ltr total capacity
- 2 x Exhaust skin fittings (stainless steel)
- 2 x Exhaust water locks
- 2 x Cooling water inlet strainers
- 2 x Exhaust cooling water temperature sensors with audible alarms at helm
- 2 x Moisture eliminating grilles

RUDDER & STEERING SYSTEM

- Balanced spade rudders in stainless steel
- Rudder stock in stainless steel
- Bearings with fiberglass rudder tube
- Hydraulic steering system
- Soft-grip steering wheel
- Compass at helm position

ELECTRICAL INSTALLATION

- **US 220V Isolated Shore Power - Includes 8kW isolation transformer with voltage booster function**
- **Includes 125/250V 50A shore power cable with stainless steel inlet, reverse Y adapter and AC switch panel**
- **Battery Charger - 12V 100A**
- **3000W 110V/60Hz inverter with integrated USB's at specified locations**
- LED Courtesy lights at stairways
- LED Bi-colour & stern navlights
- 12v DC switch panel
- 1 x 12v outlet sockets at helm station
- 2 x Double USB sockets at helm station
- 1 x Double USB socket in saloon
- 2 x Double USB sockets at nav desk
- 1 x Double USB socket in each cabin
- **Motorized TV lift in saloon**
- **4 x House batteries - AGM batteries**
- **Two additional AGM house batteries (210Ah) 6 Total**
 - 4 x Engine starter batteries - 100Ah AGM type
- 1 x House battery isolator switch
 - 2 x Engine starter battery isolator switches
- 2 x Alternators, standard with engines
- 1 x Electrical spares kit: fuses, relays, fuse holders
- 1 x Electric fog horn with control at helm station
- Digital monitoring includes:
 - 1 x Axiom 7" Multifunction Display at helm for digital systems monitoring
- 3000W Inverter dedicated for convection microwave oven
- 1200W Inverter for refrigerator
- **Fusion Marine Stereo includes:**
 - Docking station in saloon. Includes Bluetooth, USB & AUX connectivity.**
 - Fusion Marine speakers in saloon, aft cockpit, fwd cockpit & flybridge.**
 - Wired remote controls in fwd cockpit, aft cockpit & flybridge.**
- **Raymarine Base Pack includes :**
 - Ray 60 VHF (Multizone) at nav desk & additional VHF handset at helm**
 - P70 colour autopilot display**
 - i70 Colour instrument at Helmstation. With retractable depth & speed, plus wind transducer**
- **Rear-view Raymarine camera**
- **Ventilation fans in cabins**
- **Genset – Northern Lights 9kW supplied from port fuel tank. Fuel transfer ability from starboard to port tank.**
- **Chilled Water Air Conditioning:**
 - 70000BTU/h BLDC chiller unit.**
 - 2 x 12000BTU/h**
 - 4 x 5000BTU/h air handlers with 5 x digital control panels.**
 - Raw water and coolant circulation pumps.**
- **2 x Solar panels 150w each fitted to hard top**
- **2 x Underwater Lights. Blue, mounted in stern**

GENERAL EQUIPMENT

- 6 x Fire extinguishers
- Automatic Extinguishing system for engine rooms
- Owner's Operating Manual
- CE Certification NMMA Certification

SAFETY GEAR

- 55lb (25kg) Stainless Steel DTX anchor with 165ft (50m) of chain
- 35lb (15kg) Britany anchor with 26ft (8m) of chain and 200ft (61m) warp
- Anchor bridle, shackles and hook
- 6 x Fenders
- 4 x Mooring lines
- 2 x Spring lines
- 12 x Life jackets
- Safety harnesses
- Bell
- Flare Kit
- Binoculars
- Navigation tools: Parallel rule, compass, dividers

CRUISING GEAR

- Plates, cups, saucers, glasses per max pax
- Bed linens per max pax
- Flatware for twelve per max pax
- Pots, pans, miscellaneous food prep tools
- Cooking and serving utensils
- Coffee pot, tea kettle, toaster
- Snorkeling gear for per max pax
- Towels and washcloths per max pax

DELIVERY & COMMISSIONING

- Transport to Cape Town Harbor, launching, commissioning of equipment and sea trials
- Antifouling Paint
- Delivery from Cape Town to charter port

GENERAL SPECIFICATIONS

Length Overall (including platform):	16.19m / 53ft 1in
Length Overall:	15.4m / 50ft 6in
Beam:	7.67m / 25ft 2in
Draft:	0.97m / 3ft 2in
Displacement:	18629kg / 41070lb
Fuel Capacity:	2200L / 581gal
Water Capacity:	700L / 185gal
Engines:	2 x 350HP

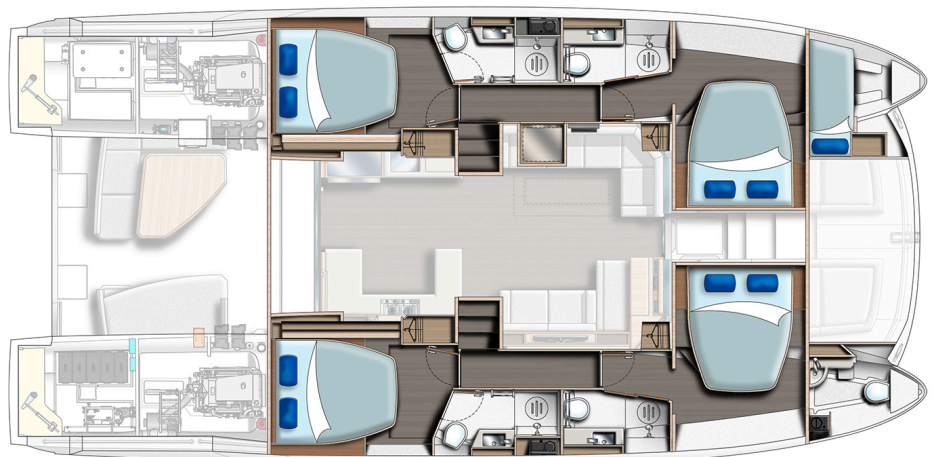

The Builder reserves the right to change or amend the contents of this document at any time without prior notification to any third party, and no liability will be accepted for errors contained within the same.