

Moorings 38.2

Specifications and Equipment List - Moorings Upgrades In Bold

DECK & HULL

- Design in accordance with European Directive requirements and according to EC certification
- Monolithic hull in polyester
- Monolithic structural hull liner bonded to the hull
- Deck injection constructed in fiberglass and Saerform foam sandwich, covered with diamond-point non-slip coating
- Hull-deck joint screwed, bonded and trimmed with 1 toerail
- Cast iron keel fixed with bolts and stainless steel backing plates
- 2 underhung rudders with stainless steel stock
- **Shoal keel**
- Self-bailing chain locker - Clench bolt - Hatch cover
- 6 Aluminum mooring cleats - Stainless steel deck line protection
- 1 Open stainless steel forward pulpit
- 2 Stainless steel aft pushpits
- **Double stainless steel lifelines uncoated and stainless steel stanchions - Access to port and starboard in lifelines**
- **White hull with Moorings graphics**
- Horseshoe buoy with holder
- **Manual, fully opening transom with gas cylinder assist, convertible into swim platform with natural solid wood decking with retrieval line (2,60 m x 0,70 m / 8ft 6in x 2ft 4in)**
- **1 Stainless steel integrated telescopic swimming ladder and backing plate with stainless steel protection**
- **1 Outboard engine bracket**
- 1 x Flag pole holder (stainless steel)
- **1000w Electric windlass with 10mm gypsey and hand control wired direct & cockpit chain counter**
- **Double stemhead anchor roller**
- **Transom protection**

COCKPIT & COMPANIONWAY

- Self-bailing cockpit
- 2 Cockpit lockers
- 1 Liferaft locker - aft cockpit (0,95 x 0,59, x 0,36m / 3ft 1in x 1ft 11in x 1ft 2in)
- **2 Gas lockers for 5lb propane bottles**
- Cockpit Tisch, Edelstahl, Getränkehalter
- **Hanging light in cockpit**
- Cockpit bench seats (1,69m x 0,50m / 5ft 7in x 1ft 8in)
- **Natural solid wood slatted cockpit benches**
- 2 Steering wheel consoles: Stainless steel steering wheels - 900 mm diameter - Steering gear at the helm station - Metal cable transmission system - Stainless steel handrail - Fixed navigation instrument pod - Glass holder
- 2 steering compasses on consoles
- **Natural solid wood slatted helm seats**
- **1 Mainsail arch (fixed, Composite, Built-in lighting)**
- **Bimini & dodger**
- 2 Deck access points to tiller system
- 1 Emergency tiller
- Portside engine control and control panel
- 2 Hinged PMMA companionway doors - Sliding hatch made of PMMA
- Companionway headroom: 1,96m / 6ft 5in
- GRP salon companionway steps are coated with non-slip surface

SALOON/INTERIOR

- **Hasp on companionway hatch**
- **Blonde oak interior**
- Parquet type laminated floors
- Saloon headroom: 1,95m / 6ft 5in
- L-shaped settee seating
- **Saloon table converts to double berth**
- Storage under bench seats
- Faux leather saloon cushions
- **Taupe interior padding**
- Fabric lined hull in saloon and forecabin
- 1 Opening deck hatch
- 1 Opening and 1 secured porthole on coaming in side windows

- **Mosquito screens for portlights**
- Chart table (with opening top)
- 2 Panoramic deck house windows
- 2 Hull portholes

MAST, RIGGING & SAILS

- **Custom heavy duty battened charter mainsail**
- **Custom heavy duty charter furling genoa with Moorings blue UV protection strips**
- **Stackpack lazy bag with Moorings logo**
- Mast 9/10 anodized aluminum installed on the deck, 2 sets of spreaders
- Anodised aluminium boom
- Discontinuous (stainless steel) standing rigging
- 1 Backstay: Bridle
- Rigid boom vang
- 2 Genoa tracks with piston adjusted traveller cars
- 2 Genoa sheet return blocks
- Rigging run back to cockpit (except boom topping lift)
- Complete running rigging: Main halyard, genoa halyard with clutch on mast and cleat, boom topping lift with cleat on mast, mainsheet, 2 x genoa sheets, 2 x reef points
- **Genoa Profurl furling system with drum on the deck**
- 4 x clutches, 2 x jamming cleats
- 2 Self-tailing Harken genoa sheet winches (H40.2 STA)
- 1 x Self-tailing Harken coachroof winch (H35.2 STA)
- 2 Aluminum winch handles
- 2 Winch handle holders
- **Windex wind vane**
- **Alloy sheaves & gooseneck bushing**
- **Protection guard on steaming light**

GALLEY

- Galley headroom: 1,97 / 6ft 6in
- **Compact grey laminated worktop**
- 1 Stainless steel sink 1 rectangular basin - 1 Mixer tap cold water / hot water, under pressure
- 1 Cubby hole locker
- 1 Gas stove 2 burners - Stainless steel oven on gimbal mountings - Stainless steel protection handrail
- Drawers and cupboards
- 1 x 12v 130 L refrigerator / 34 US Gal, front opening
- 1 Base cabinet: 1 Drawer - 2 shelves
- Large coachroof window
- **Propane solenoid valve**

FORWARD CABIN

- Forward Cabin Headroom: 1,95m / 6ft 5in
- Central double berth (2,08 x 1,50 x 1,08m / 6ft 10in x 4ft 11in x 3ft 7in)
- **Grey covered foam mattress**
- Valet tray - Open shelving - Drawer under the bed
- 1 Flush deck hatch
- 2 Hull portholes

PORT AFT HEAD

- Port Aft Head headroom: 1,89m / 6ft 2in
- Access through the saloon
- Sink - 1 mixing tap hot/cold water
- Washroom cabinet & mirror
- Toilet accessories
- 1 Opening portlight in side windows in the coaming
- **Large bowl Quiet Flush electric marine toilet with individual holding tank**

PORT AFT CABIN

- Double berth (2,18 x 2,05 x 1,65m / 7ft 2in x 6ft 9in x 5ft 5in)
- **Grey covered foam mattress**
- Bulkhead with one access door
- Large hanging locker with overhead light
- Open shelving
- Opening portholes: Roof and cockpit

ELECTRICAL INSTALLATION

- 2 Fixed shore power cables
- 12v circuit for house and engine systems, 12v plugs at nav station, 110/220v plugs in each cabin, saloon, chart table and galley
- 12v Electrical panel (Fuses - Voltmeter - Water gauge - Fuel gauge - Battery warning - Fuel warning - Water warning)
- 1 x 12v Power outlet
- 110v or 220v circuit shore-power outlets distributor
- 1 x 110ah Lead acid engine battery
- **House battery bank -- 3 Dryfit gel batteries totalling 255ah**
- Wire runs for optional cables
- **LED navigation and anchoring lights**
- **LED lights throughout**
- **Fans in saloon and all cabins**
- **2 x USB ports in each cabin**
- **Fusion 700i Radio / Mp3 player + 2 interior speakers + 2 cockpit speakers**
- **TV/DVD and bracket in the saloon**
- **Shore power Air Conditioning**
- **Battery charger 60amp**
- **7" Multifunction touchscreen display in cockpit (WIFI enabled)**
- **1 x Tridata**
- **1 x Autopilot control head**
- **Hydraulic linear drive autopilot**
- **Depth sounder & anemometer windvane**
- **VHF with AIS (receiving only)**
- **Flush mounted solar panels totalling 125w with charge controller**
- **Moorings marine smarthub (wifi via cellular network and stored local content)**
- **2 x 50w Solar panels**

AFT STARBOARD SHOWER

- **Stand-alone walk-in shower accessed from saloon**
- Automated shower drain

STARBOARD AFT HEAD

- Starboard Aft Head headroom: 1.89m / 6ft 2in
- Accès par le carré
- Sink - 1 mixing tap hot/cold water
- Washroom cabinet & mirror
- Toilet accessories
- 1 Opening portlight in side windows in the coaming
- 1 Overhead light
- **Large bowl Quiet Flush electric marine toilet with individual holding tank**

ENGINE & CONTROLS

- **Yanmar 3YM30AE -- 29 hp diesel engine with sail drive**
- Engine control - Control panel in cockpit
- Engine compartment: Soundproofing foam - Ventilation: 2 x air intakes and exhaust fan
- 1 Rotomoulded diesel tank 130L / 34USgal
- Deck filler
- **Fuel filter - Racor - Clear bowl and metal flame deflector**
- Electronic fuel gauge at chart table
- 3-Blade fixed propeller
- 1 x Engine access through companionway
- 3 x Engine access by sides of companionway
- 1 Alternator 12v / 125 Amp
- Seawater filter

PLUMBING INSTALLATION

- 1 x rotomoulded freshwater tank (130L / 34USgal)
- **1 x Extra water tank 200L / 53USgal**
- 1 x Deck filler
- Automated shower drains
- **1 x Water heater 40L / 10USgal**
- Waterpressure system - Expansion tank - Inline filter
- 1 Electric bilge pump - 1 Manual bilge pump
- **Transom shower with hot and cold water mixer**

SAFETY GEAR

- **Primary (stainless steel) and secondary (galvanized) anchors**
- **6 x Fenders**
- **6 x Mooring / dock lines**
- **Lifejackets and safety harnesses per max pax**
- **Safety harnesses**
- **Bell**
- **Flare kit**
- **Binoculars**
- **Navigation tools: Parallel rule, compass, dividers**

CRUISING GEAR

- **Bed linens per max pax**
- **Plates, cups, saucers, glasses per max pax**
- **Flatware per max pax**
- **Pots, pans, miscellaneous food prep tools**
- **Cooking and serving utensils**
- **Coffee pot, tea kettle, toaster**
- **Towels and washcloths per max pax**
- **Snorkeling gear per max pax**
- **Cockpit cushions per max pax**

GENERAL SPECIFICATIONS

Length Overall:	11.50m/37ft 9in
Waterline Length:	10.72m/35ft 2in
Beam:	3.99m/13ft 1in
Draft:	1.64m/5ft 5in
Displacement:	6850kg/15097lb
Fuel Capacity:	130L/34gal
Water Capacity:	330L/87gal
Engine:	Yanmar 29hp Sail Drive

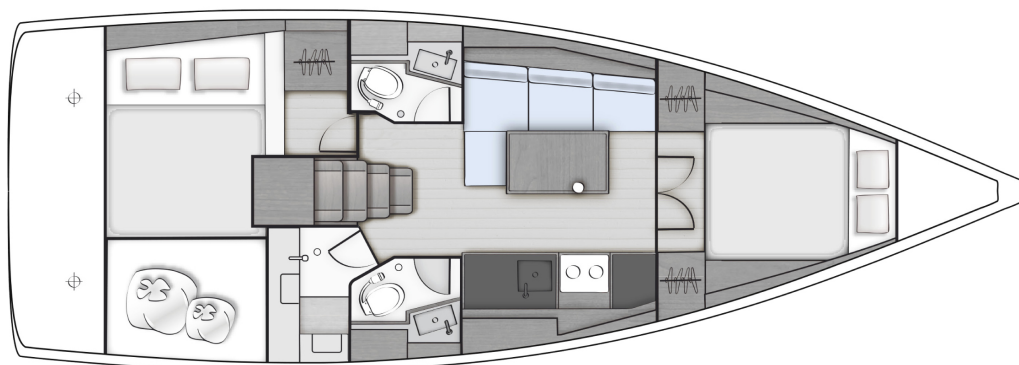

The Builder reserves the right to change or amend the contents of this document at any time without prior notification to any third party, and no liability will be accepted for errors contained within the same.